

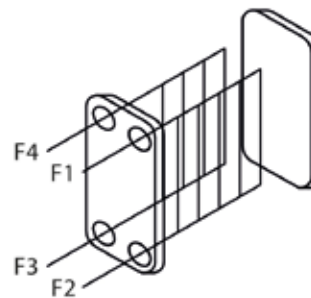

S.T.B. DIVISIONE WINTER s.r.l.

SP - S20

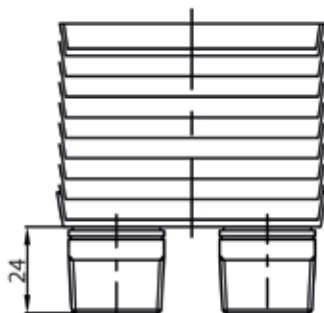
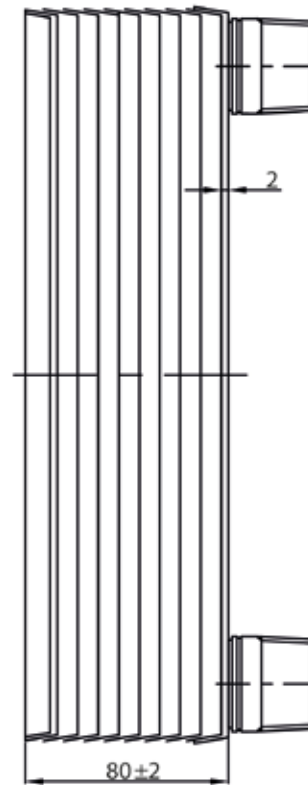
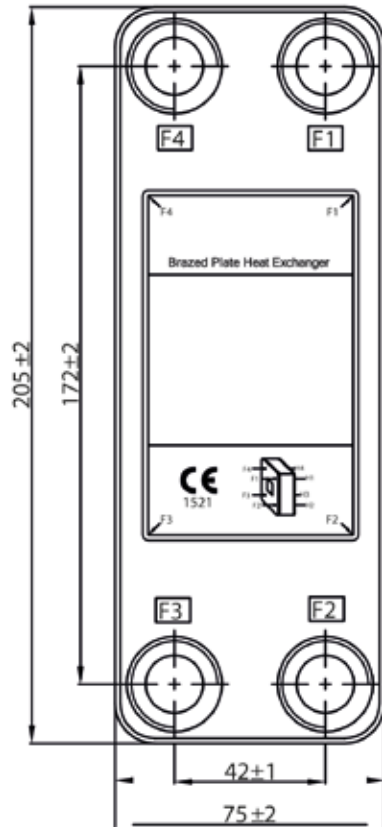

R3/4" B Connection(L012) R3/4" B Connection(L012C)

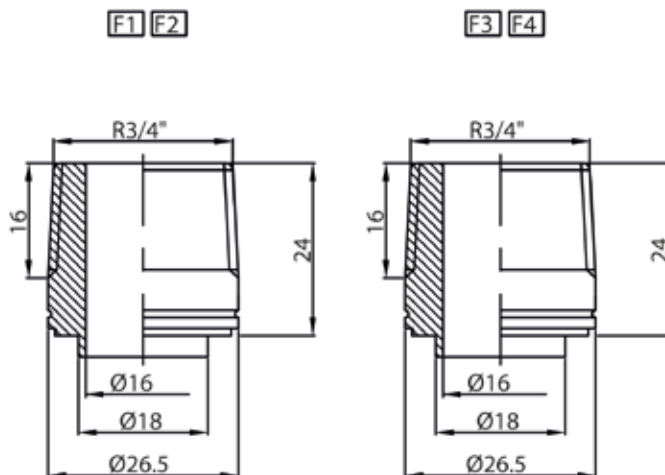

SP - S20	
Design pressuer(MPa)	3.0
Testing pressuer(MPa)	4.5
Design Temperature(°C)	-196 ~ +200 °C
Volume(L)	F1F2side:0.30 ; F3F4side:0.28
Heat transfer area(m ²)	0.39
Weight(kg)	2.0
Customer Part No.	
Label Code	FH-Label-07

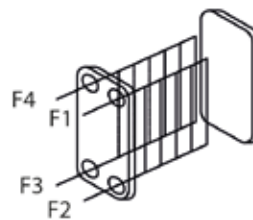
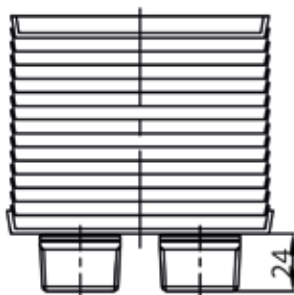
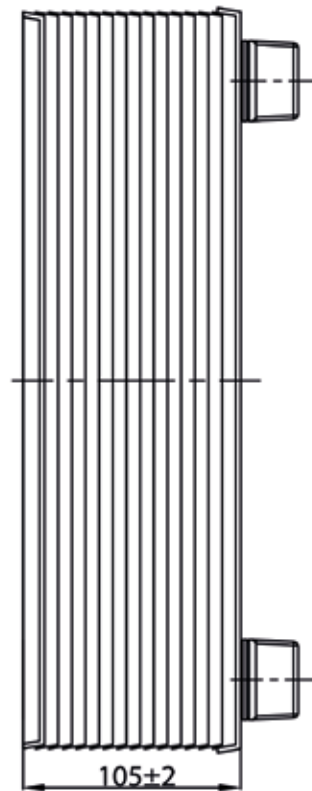
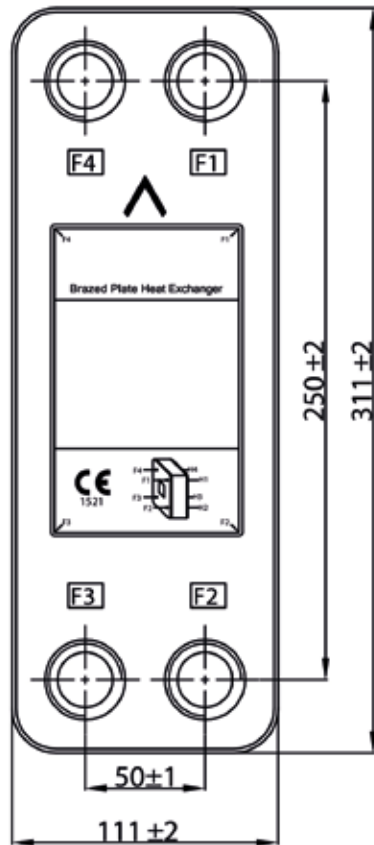

R1" Connection(L015)

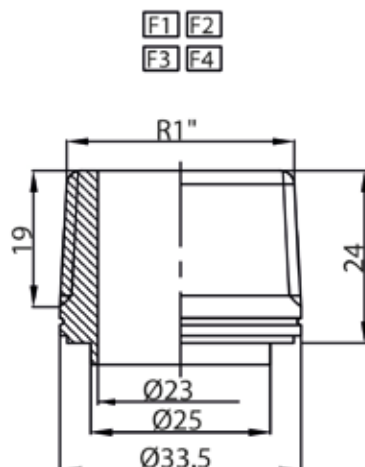

SP - S27	
Design pressuer(MPa)	3.0
Testing pressuer(MPa)	4.5
Design Temperature(°C)	-196 ~ +200 °C
Volume(L)	F1F2side:1.0 ; F3F4side:0.95
Heat transfer area(m ²)	1.06
Weight(kg)	4.39
Customer Part No.	
Label Code	FH-Label-08

SP - S52

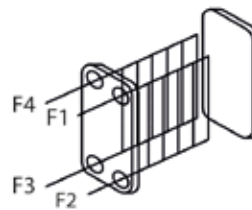
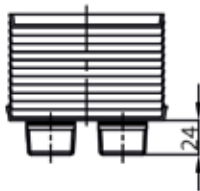
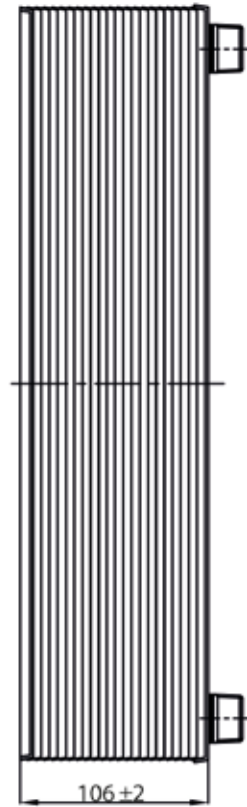
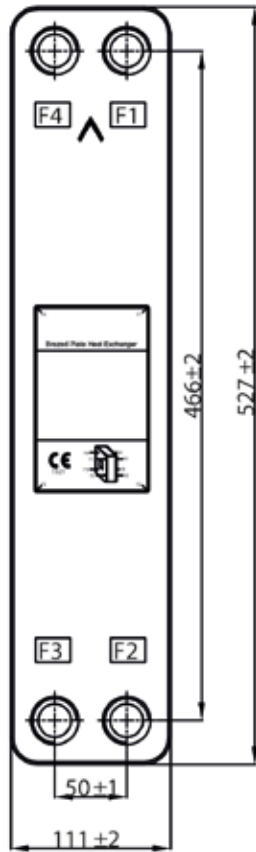

R1"Connection(L015)

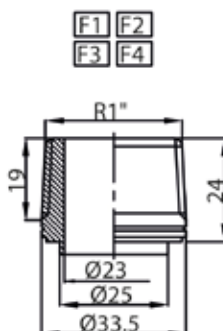

SP - S52

Design pressuer(MPa)	3.0
Testing pressuer(MPa)	4.5
Design Temperature(°C)	-196 ~ +200 °C
Volume(L)	F1F2side:1.88 ,F3F4side:1.79
Heat transfer area(m ²)	1.98
Weight(kg)	10.80
Customer Part No.	
Label Code	FH-Label-08

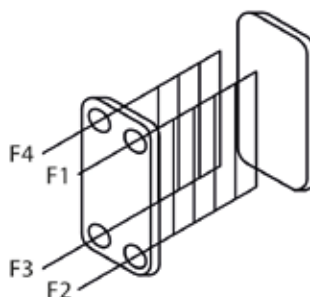
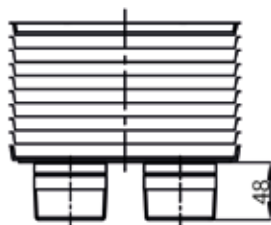
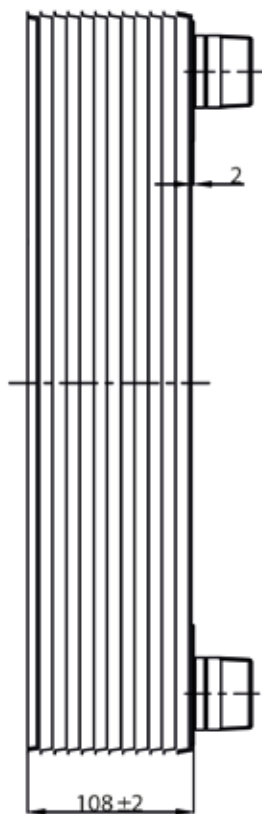
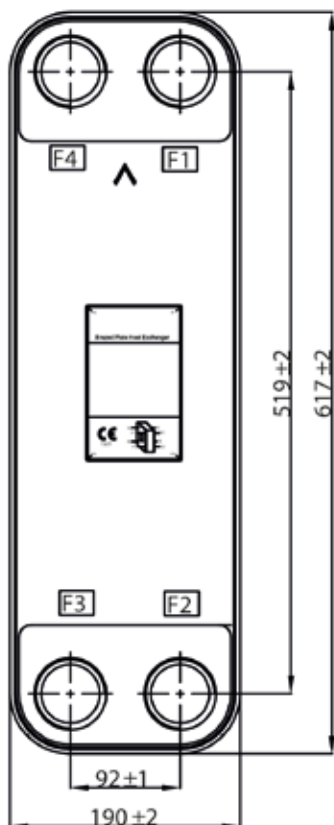

R2" Connection(L024)

F1 F2
F3 F4

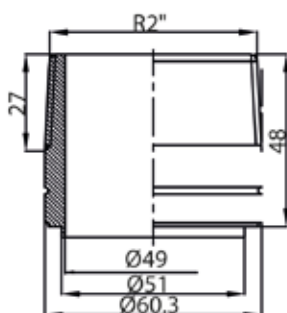

SP - S76

Design pressuer(MPa)	3.0
Testing pressuer(MPa)	4.5
Design Temperature(°C)	-196 ~ +200 °C
Volume(L)	F1F2side:4.20 ;F3F4side:3.99
Heat transfer area(m²)	3.61
Weight(kg)	22.96
Customer Part No.	

SP - S200

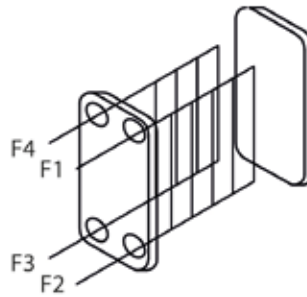
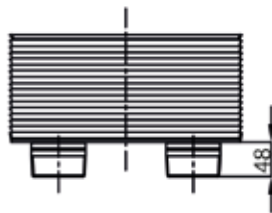
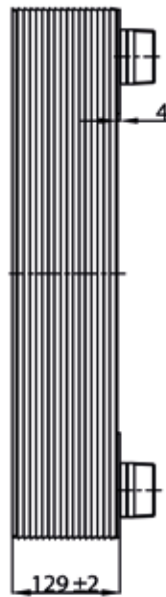
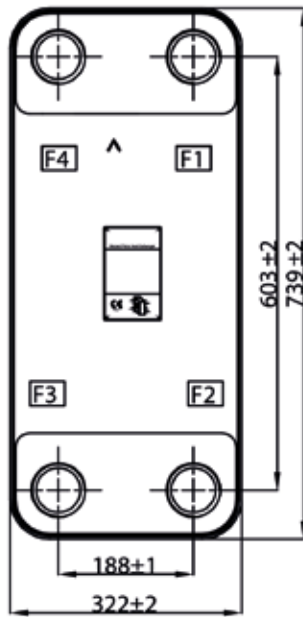

R2"1/2Connection(L027C)

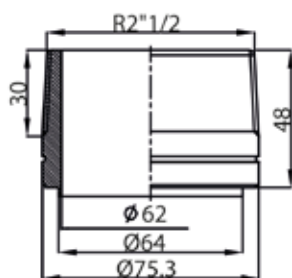

SP - S200

Design pressuer(MPa)	3.0
Testing pressuer(MPa)	4.5
Design Temperature(°C)	-196 ~+200 °C
Volume(L)	F1F2side:8.0;F3F4side:7.60
Heat transfer area(m²)	7.98
Weight(kg)	45.9
Customer Part No.	
Label Code	FH-Label-08

	SP-S20	SP-S27	SP-S52	SP-S76	SP-S200
Misura attacchi S3-S4/S1-S2	¾"	1"	1 ¼"	2"	2 ½"
Volume per canali [litri]	0.02	0.05	0.09	0.21	0.39
Altezza c [mm]	205	311	526	618	739
Larghezza d [mm]	75	112	112	191	322
Interasse a [mm]	172	250	466	519	603
Interasse b [mm]	42	50	50	92	188
Interasse A mm	9+2.3n	9+2.3n	9+2.4n	11+2.4n	11+2.4n
Peso a vuoto [kg]	9+2.3 n	9+2.3 n	9 + 2.4 n	11+2.4 n	13+2.85 n
Materiale delle piastre	AISI 316				
Materiale raccordo	AISI 316				
Materiale di brasatura	Rame				

n = NUMERO PIASTRE

